

What's so unique about PATH's ABR? Any references or publications?

In contrast to competing manufacturers of ABR devices, Sentiero is the only device to do diagnostic ABR on a battery powered handheld device (power loss? No problem!) in a non-sedated setup in any room (no need for special shielding). External sources of electrical disturbances have less impact on the new weighted averaging algorithms with its powerful signal processor.

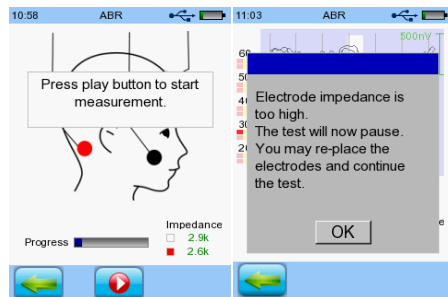

Calibration and continuous impedance checks help to increase quality of results and reduce time of measurement.

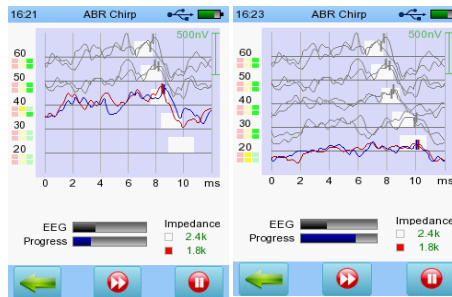

The evolution of an ABR measurement with automated peak marking and statistical evaluation of results (traffic lights).

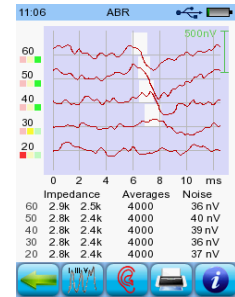

Detailed diagnostic results. Zoom in and out and get more information via a simple touch!

Sentiero's ABR has 5 different presets to be adapted and configured to your needs. It follows international standards and recommendations and even **enables you to do bone ABR**. Sentiero Advanced features a modern ABR engine, which provides several **improvements in comparison to standard methods**.

Stimulation: The stimulus generation makes use of a **jitter feature**, which randomizes the inter-stimulus intervals by about +/-1ms. This makes the system much more **robust against periodic external interference**. Additionally, the **jittering is modified** depending on the current ABR recording state, to make it even more effective in **avoiding stimulus rates** that coincide with possible interference frequencies. If **binaural testing** is selected, jittering is mandatory and effectively **decouples the response** that is evoked by the two stimulus channels. **This allows a high performance binaural testing with just 3 electrodes to be placed**. Save 25% on consumables!

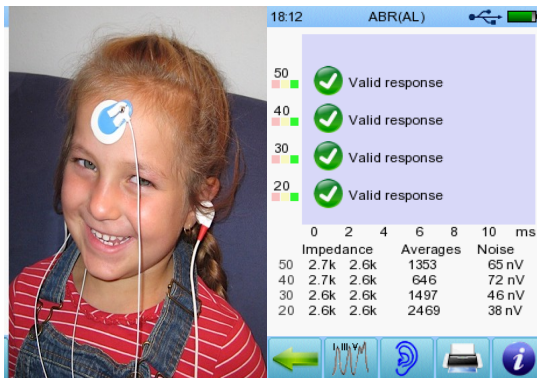

Recording: The first step of the signal processing involves **filtering against popular mains frequencies** (50Hz, 60Hz) and an **adaptive filter**. The signal is then bandpass-filtered and stimulus-synchronous **frames** are then **weighted depending on their noise content**. The weighted frames are then **averaged, if binaural recording is selected, independently for both channels (ears)**. In parallel, statistical properties of the frames are monitored, to make a **statistical evaluation possible at any stage of the test**. The statistical evaluation contains **wave-5 auto peak marking**. A traffic light symbol will indicate the **statistical significance for each trace**. This allows to pass to the next level in the test setup or to stop the test manually or automatically. All this can be (re-) configured to your 5 presets. The device itself memorizes your last presets used, you can access them with a simple swipe and touch on the screen!

Literature: Rosner, T., Brandl, B., Janssen, T. and Oswald, J., (2013). Normative data for frequency-specific chirp ABR on a handheld device, manuscript in preparation for J. Acoust. Soc. Am. Did you check out the DEMO mode on your Sentiero Advanced yet? 15 days free of charge trials of full featured modules and tests! Do you want to upgrade?

Address of buyer, special remarks and signature of sales representative: